

Enclosed fork tips  
Unique controls  
Acid-resistant chassis  
Robust and reliable  
Compact and manoeuvrable  
Grease nipples on  
all moving parts



## **AM I20/I20p**

**Stainless steel hand pallet truck (2,000 kg)**

The Jungheinrich AM stainless steel hand pallet truck is ideal for use in damp and hostile environments. The stainless steel construction provides unrivalled hygiene. A whole range of models are available, depending on the application.

Jungheinrich's decades of experience in stainless steel hand pallet trucks are reflected today in its reliable and robust trucks. In meat or fish processing, chemical or pharmaceuticals sectors, Jungheinrich stainless steel hand pallet trucks offer the right solution.

# AM I20/I20p

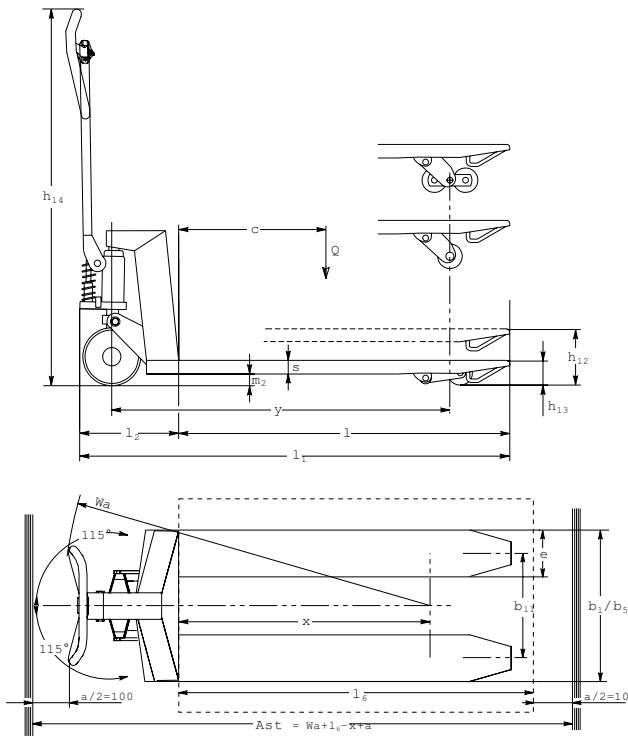

## AM I20

Not all environments require trucks to be made of 100% stainless steel. Only those parts which come into direct contact with food must be made of stainless steel. Many components however need only be moisture-repellent. Consequently, the components of the AM I20 consist of a number of different surfaces.

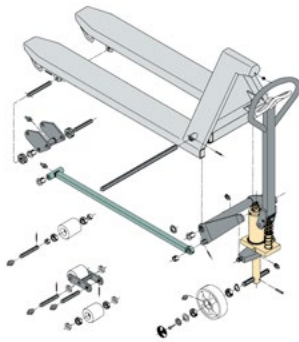

AM I20

- Electro plating
- Chromite coating
- Stainless steel (AISI 303/304)
- Acid resistant stainless steel (AISI 316)

## AM I20p

The AM I20p is 100% rust-proof and has been designed especially for applications where hygiene is of the essence and for use in particularly hostile environments. The hydraulics are protected; no foreign bodies or water can penetrate the truck.

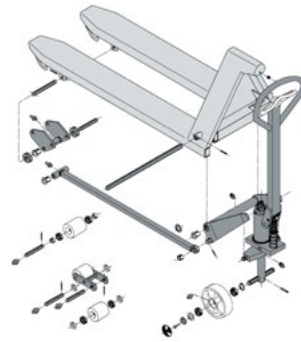

AM I20p

# Technical data in line with VDI 2198

			Jungheinrich								
			AM I20	AM I20p	AM I20	AM I20p	AM I20	AM I20p			
Identification	1.1	Manufacturer (abbreviation)									
	1.2	Model									
	1.3	Drive	manual								
	1.4	Manual, pedestrian, stand-on, seated, order picker operation	hand								
	1.5	Load capacity/rated load	Q	t	2						
	1.6	Load centre distance	c	mm	400	400	500	500	600	600	
	1.8	Load distance	x	mm	645	645	805	805	975	975	
	1.9	Wheelbase	y	mm	875	875	1,035	1,035	1,170	1,170	
	Weights	2.1	Service weight			kg	64	64	66	66	68
2.2		Axle load with load front/rear			kg					636 / 1,432	636 / 1,432
2.3		Axle load without load front/rear			kg					21 / 47 <sup>2)</sup>	21 / 47 <sup>2)</sup>
Wheels / frame	3.1	Tyres	N,V								
	3.2	Tyre size, front			mm	Ø 200x50					
	3.3	Tyre size, rear			mm	Ø 80x90 <sup>3)</sup>					
	3.5	Wheels, number front/rear (x = driven wheels)				2/2 or 2/4					
	3.6	Tread width, front	b <sub>10</sub>	mm	130						
	3.7	Tread width, rear	b <sub>11</sub>	mm	360						
	Basic dimensions	4.4	Lift	h <sub>3</sub>		mm	115				
4.9		Height of tiller in drive position min. / max.	h <sub>14</sub>		mm	1,220					
4.14		Standing height raised	h <sub>12</sub>		mm	200					
4.15		Height, lowered	h <sub>13</sub>		mm	85					
4.19		Overall length	l <sub>1</sub>		mm	1,150	1,150	1,310	1,310	1,480	1,480
4.20		Length to face of forks	l <sub>2</sub>		mm					340	340
4.21		Overall width	b <sub>1</sub> /b <sub>2</sub>		mm	520 <sup>1)</sup>					
4.22		Fork dimensions	s/e/l		mm	45 / 160 / 810	45 / 160 / 810	45 / 160 / 970	45 / 160 / 970	45 / 160 / 1,140	45 / 160 / 1,140
4.25		Width across forks	b <sub>5</sub>		mm	520 <sup>1)</sup>					
4.32		Ground clearance, centre of wheelbase	m <sub>2</sub>		mm	38					
4.33		Aisle width for pallets 1000 x 1200 sideways	Ast		mm	1,610					
4.34	Aisle width for pallets 800 x 1200 lengthways	Ast		mm	1,810						
4.35	Turning radius	W <sub>a</sub>		mm	934	934	1,094	1,094	1,774	1,774	
Perform- ance data	5.3	Lowering speed, laden/unladen			m/s					0.09 / 0.04	0.09 / 0.04

<sup>1)</sup> 680 mm also possible

<sup>2)</sup> Width 520 mm

<sup>3)</sup> Ø 80x70 mm tandem tyres

# Benefit from the advantages



AM I20 controls



Enclosed fork tips



In operation

## Easy to operate

The easy to operate handle is suitable for both left and right-handers. The special lowering valve enables loads to be lowered precisely.

## Optimum hygiene

The enclosed fork tips ensure that no dirt can spray up through the fork tips to the load. Freely accessible or fully enclosed cavities allow for effective cleaning with no hiding places for bacteria. Grease nipples on all moving parts and food-grade grease (class H1 and H2) complete

the solution.

## Fast transportation

The very short chassis length of 340 mm allows for safe and easy operation even in confined spaces. Brackets on the fork tips enable the forks to extend and retract easily.

مجموعة الجذور  
العربية

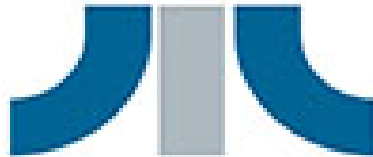

Roots Group  
ARABIA

Earth Moving and Material Handling Equipment  
Jeddah-Al-Nahda Dist-Prince Sultan Str.  
Kingdom of Saudi Arabia  
P.O. Box 52269 Jeddah 21563  
Email [kbahaa@arabian-roots.com](mailto:kbahaa@arabian-roots.com)  
Mob +966 590950582  
Tel +966 126996628 Ext: 245  
Fax +966 126221473

## Jungheinrich Aktiengesellschaft

Friedrich-Ebert-Damm 129  
D-22047 Hamburg  
Telephone +49 40 6948-0  
Telefax +49 40 6948-1777

[info@jungheinrich.com](mailto:info@jungheinrich.com)  
[www.jungheinrich.com](http://www.jungheinrich.com)

The German production facilities in Norderstedt, Moosburg and Landsberg are certified. **ISO 9001**  
**ISO 14001**

Jungheinrich fork lift trucks meet European safety requirements.



**JUNGHEINRICH**  
Machines. Ideas. Solutions.